



WORLD  
TRADE  
CENTER





# The Best of Four

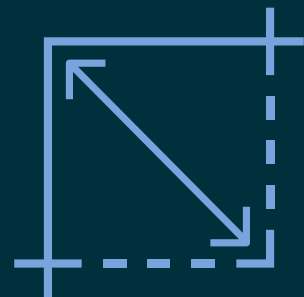

**OPEN &  
EFFICIENT  
FLOOR PLATES**

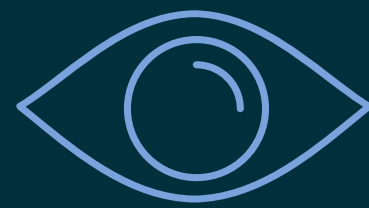

**JAW-  
DROPPING  
VIEWS**



**VIBRANT  
NEIGHBORHOOD  
WITH IN-BUILDING  
TRANSIT ACCESS**



**STUNNING  
ICONIC  
ARCHITECTURE**

**ADDRESS**

150 Greenwich Street  
New York, NY 10007

**SIZE**

2.3 million square feet

**ARCHITECT**

Fumihiko Maki

**SLAB HEIGHT**

Slab to slab: 13.5'

**HEIGHT**

72 floors / 977 feet

**WINDOWS**

Floor to ceiling glass



WEST FACADE



# Premier Availabilities

[VIEW AVAILABILITIES](#)

**46<sup>th</sup> Floor**  
44,716 RSF

**28<sup>th</sup> Floor**  
43,019 RSF

**44<sup>th</sup> Floor  
Built Space**

- 13,012 RSF
- 9,192 RSF

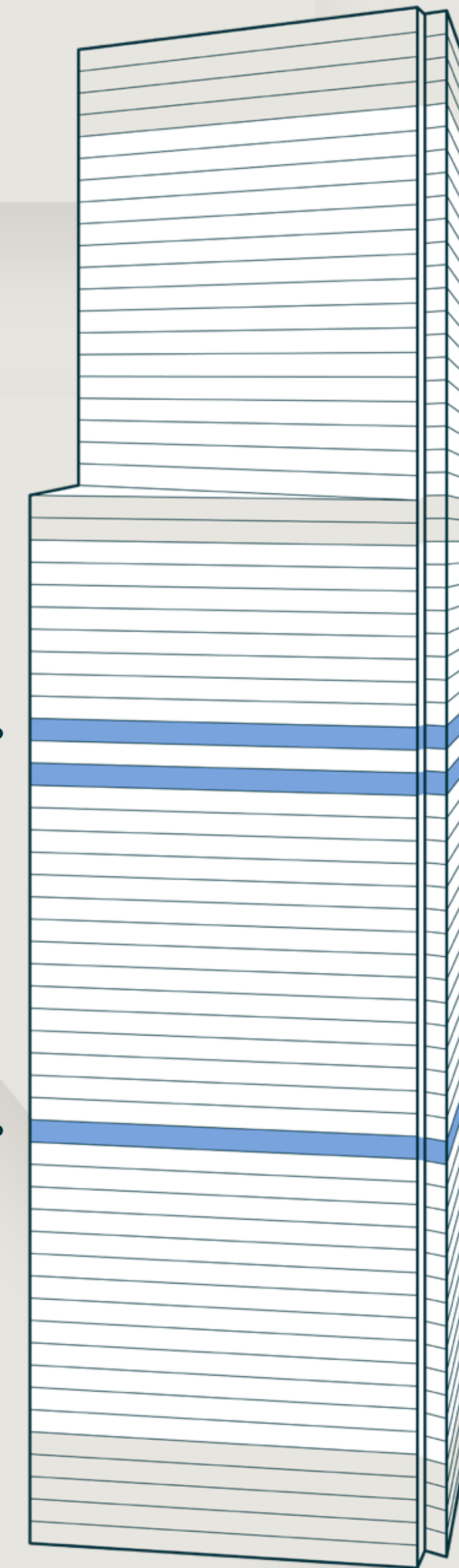







# 46<sup>th</sup> Floor

44,716 RSF

## EXISTING CONDITIONS

### GENERAL INFORMATION

Total Seats	347
-------------	-----

### WORKSPACE & SUPPORT

	COUNT
Private Offices	6
Conference Rooms	11
Multipurpose	1
Auditorium	1
Phone Rooms	8
Workstations	340
Reception	1
Collaboration	8
Pantry	1
Yoga Studio	1
Wellness	1
Copy	2
IT	2
Mailroom	1
Storage	1
Office Supplies	1
Coats	4

[TAKE A VIRTUAL TOUR](#)





LIBERTY ST.



# 44<sup>th</sup> Floor (P)

Built Space | 13,012 RSF

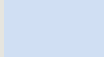
## EXISTING CONDITIONS

WORKSPACE & SUPPORT		COUNT
	Office	1
	Conference Rooms	3
	Flex Space	1
	Workstations	62
	Lounge Areas	2
	Pantry	1
	Reception	1

[TAKE A VIRTUAL TOUR](#)

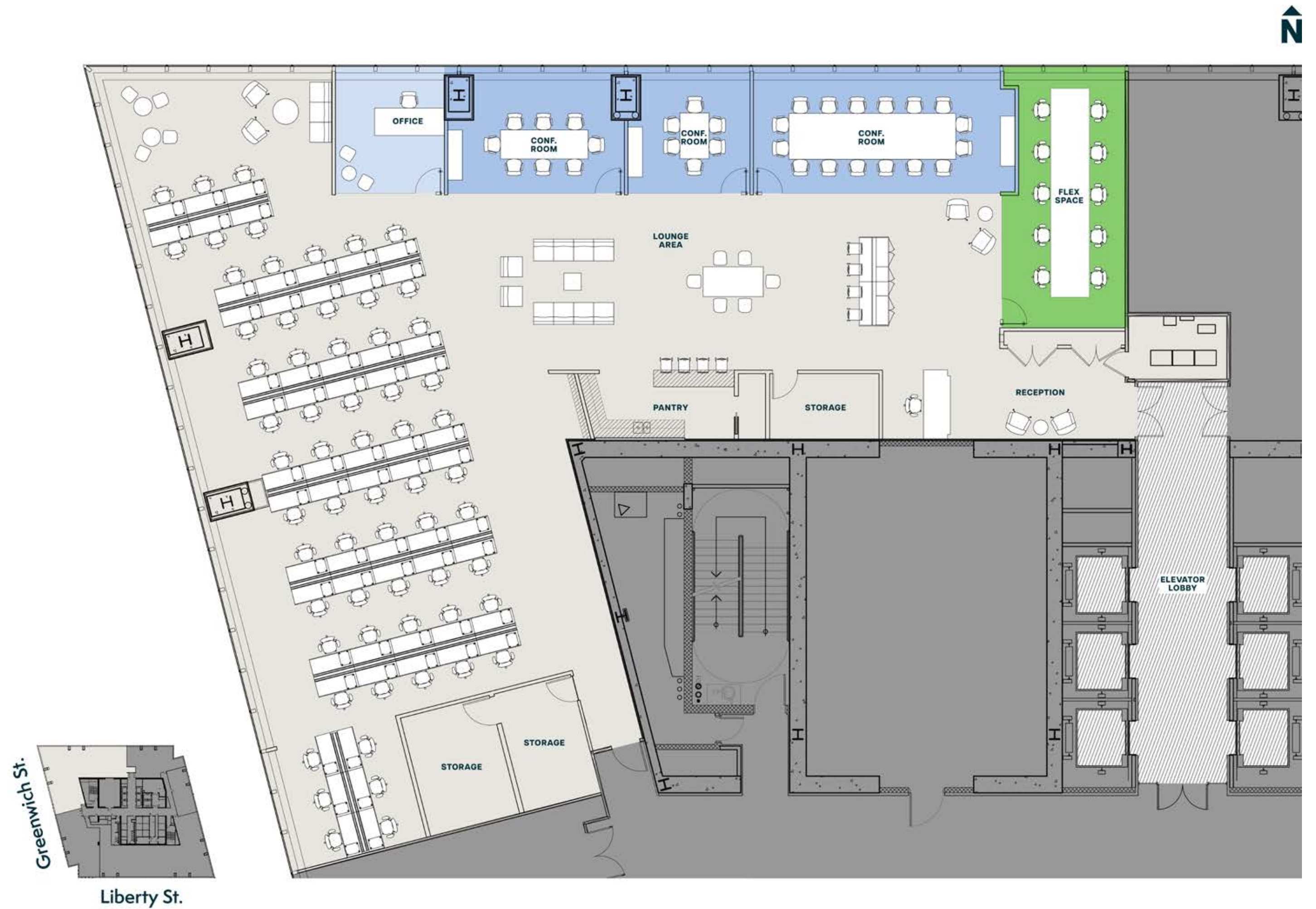



# 44<sup>th</sup> Floor (P)

Built Space | 9,192 RSF

## EXISTING CONDITIONS

### GENERAL INFORMATION

Total Seats	64
-------------	----

### WORKSPACE & SUPPORT

	COUNT
Offices	9
Conference Rooms	2
Workstations	52
Pantry	1
Storage / IT	1

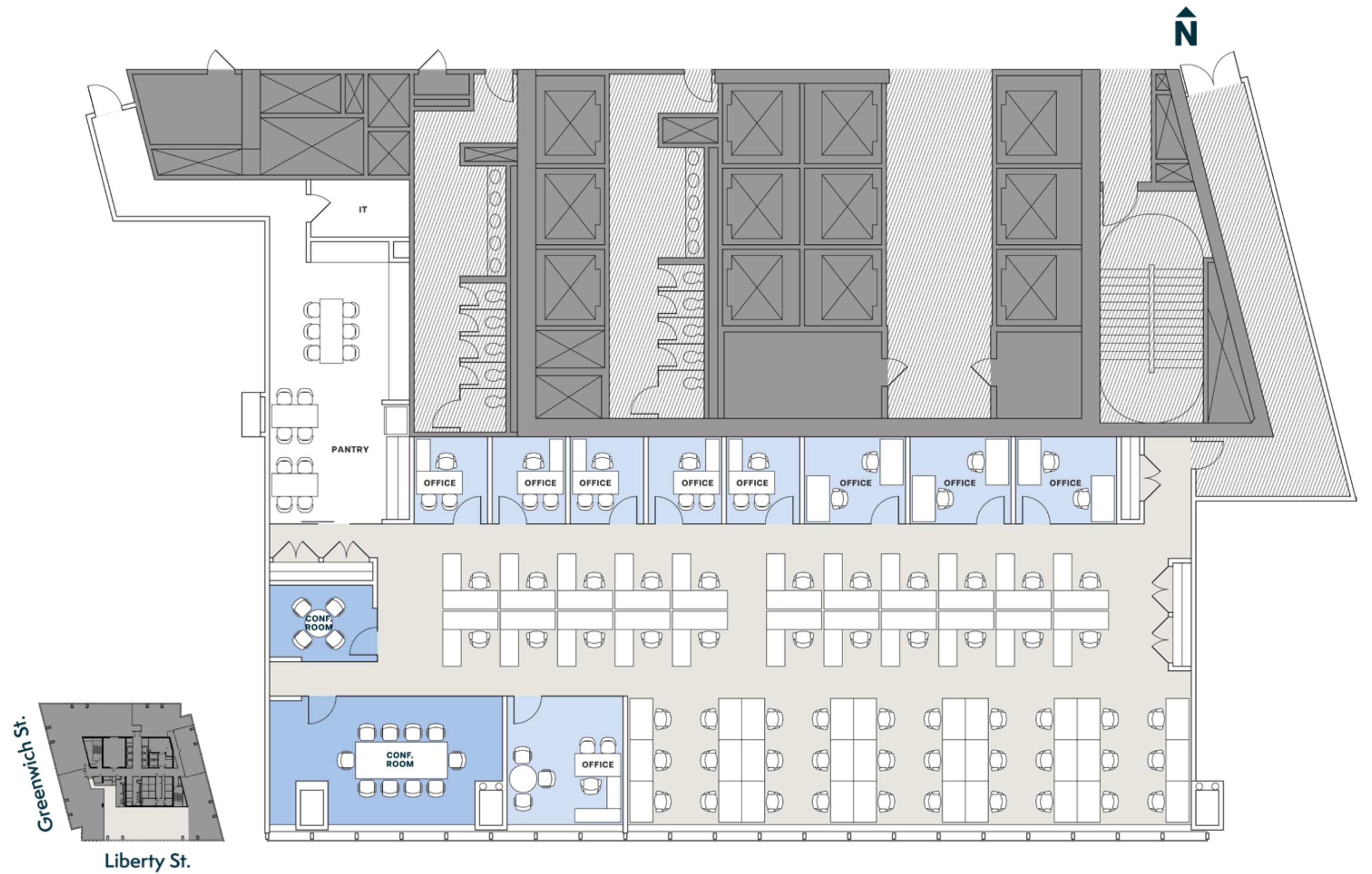



# 28<sup>th</sup> Floor

43,019 RSF

## PROPOSED OPEN LAYOUT

### GENERAL INFORMATION

Total Seats	213
-------------	-----

### WORKSPACE & SUPPORT

	COUNT
Private Offices	21
Conference Rooms	6
Workstations	192
Open Collaboration	7
Reception	1
Pantry	2
Copy	2
IDF	2
Mailroom	1
Files	1
Storage	1



LIBERTY ST.





**44<sup>TH</sup> FLOOR BUILT SPACE (13,012 RSF) – COLLABORATIVE SPACE**



**VIEW-NORTH**



**44<sup>TH</sup> FLOOR BUILT SPACE (9,192 RSF) – CONFERENCE ROOM**



**VIEW-WEST**



**44<sup>TH</sup> FLOOR BUILT SPACE (13,012 RSF) – COLLABORATIVE SPACE**



# Everything On Tap

World Trade Center tenants enjoy convenient, contactless access to the buildings' main entrances, amenities, and other tenant-exclusive spaces via their iPhone or Apple Watch, simply by adding their access badge to Apple Wallet.

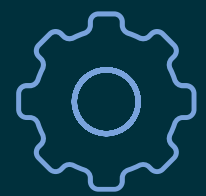

SEAMLESS SET-UP



EXPRESS MODE ACCESSIBILITY



SECURE & PRIVATE

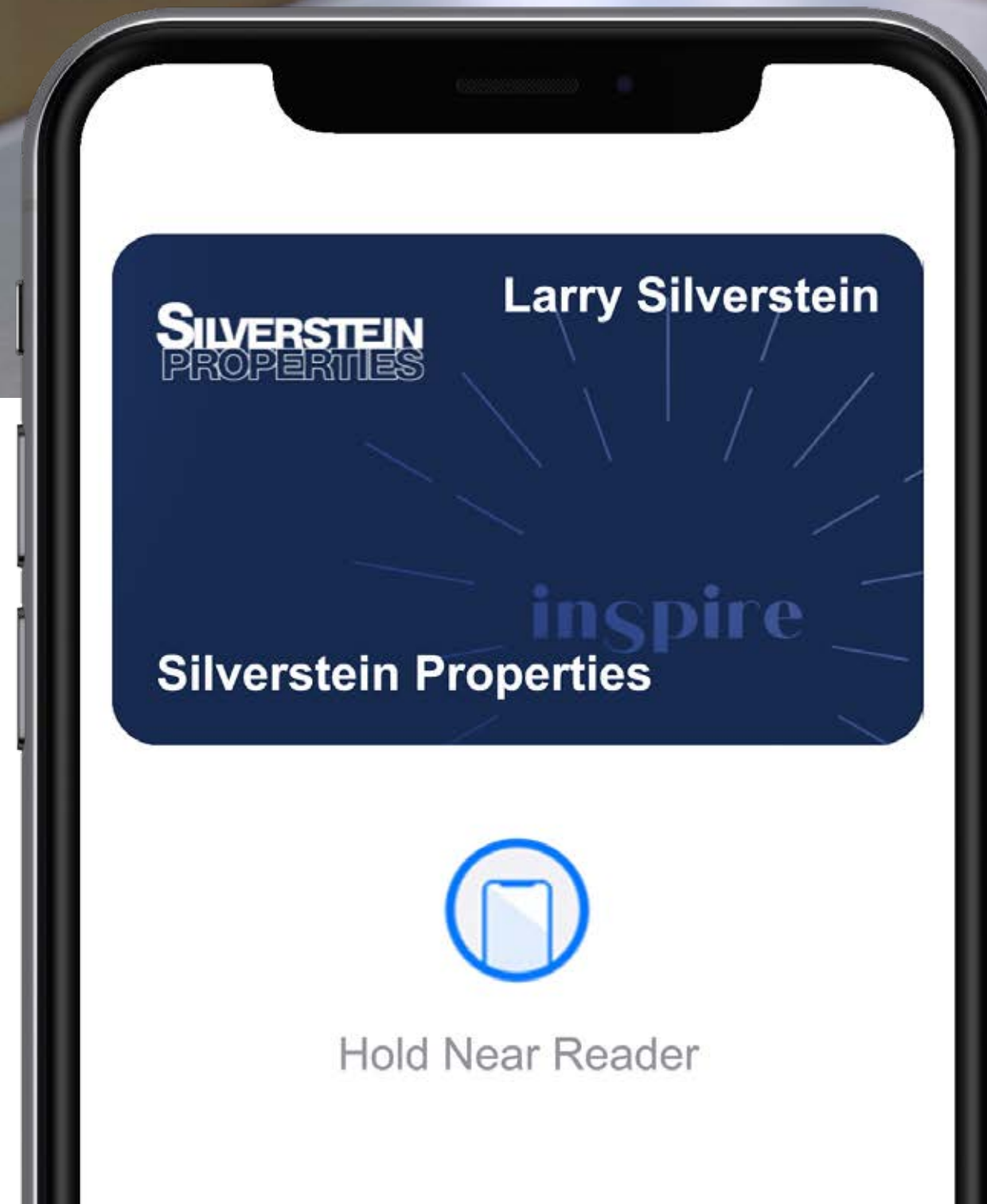





# Get Inspired

Inspire is a hospitality-infused program offering a suite of services, programming, amenity spaces and on-demand workspaces for today's flexible workforce, allowing customers to choose the best work environment for their needs.

Through the Inspire program, 4 WTC occupants enjoy access to all the co-working and amenity spaces across every office building in the Silverstein portfolio.



**FLEXIBLE WORK  
& MEETING  
SPACES**

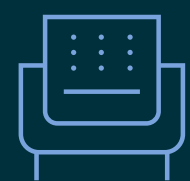

**OPEN WORK  
& LOUNGE  
SPACE**

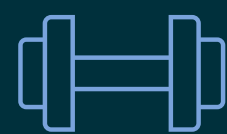

**WELLNESS  
& SOCIAL  
PROGRAMMING**



**IN-OFFICE  
FOOD  
DELIVERY**



**CONCIERGE  
SERVICES**



**DISCOUNTS**



**INSPIRE  
APP**

[INSPIREYOURDAY.COM](https://inspireyourday.com)







**THE TERRACE**  
3 World Trade Center | New York, NY



**THE LANDMARK**  
120 Broadway | New York, NY



**THE LOUNGE**  
1735 Market Street | Philadelphia, PA



**THE BANKERS CLUB**  
120 Broadway | New York, NY



**THE STUDIO**  
7 World Trade Center | New York, NY



**SEVENTEEN**  
1177 Avenue of the Americas | New York, NY



# The City's Most Connected Campus

Quickly get to anywhere in the city via Downtown's transit hubs—The Oculus and Fulton Center—without ever stepping outside.

12 SUBWAY LINES ARE LESS THAN 2 MINUTES AWAY

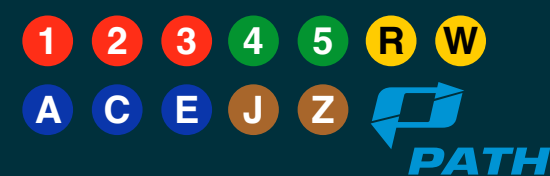

OVER 800,000 REGIONAL CREATIVE AND PROFESSIONAL WORKERS

1-SEAT RIDE TO DOWNTOWN

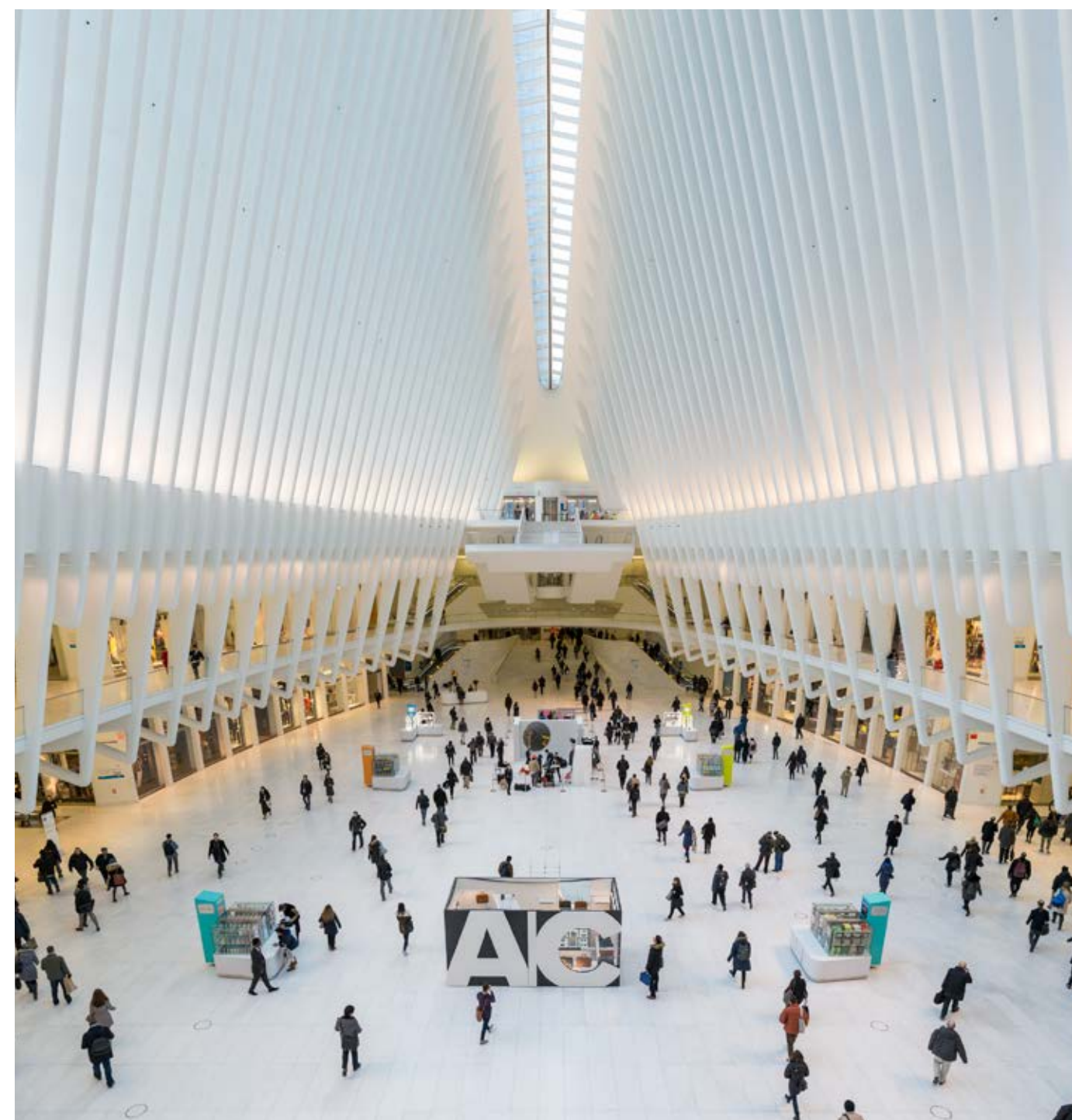

## The Oculus Transportation Hub

12 Subway Lines and PATH Trains



## Bicycle, Skate, or Walk

Access to Brooklyn, Manhattan, and Williamsburg Bridges



## NYC Waterway Ferry

To/From Midtown Manhattan, New Jersey, Queens and Staten Island



## Fulton Center

12 Subway Lines



## Driving

Black car and taxi drop-off directly in front of 4 WTC along Greenwich Street



# Everything Within Reach

-  **FITNESS**
-  **HOTELS**
-  **MUSEUMS**
-  **CASUAL EATS**
-  **DINNER SPOTS**
-  **BARS**
-  **CAFÉS**

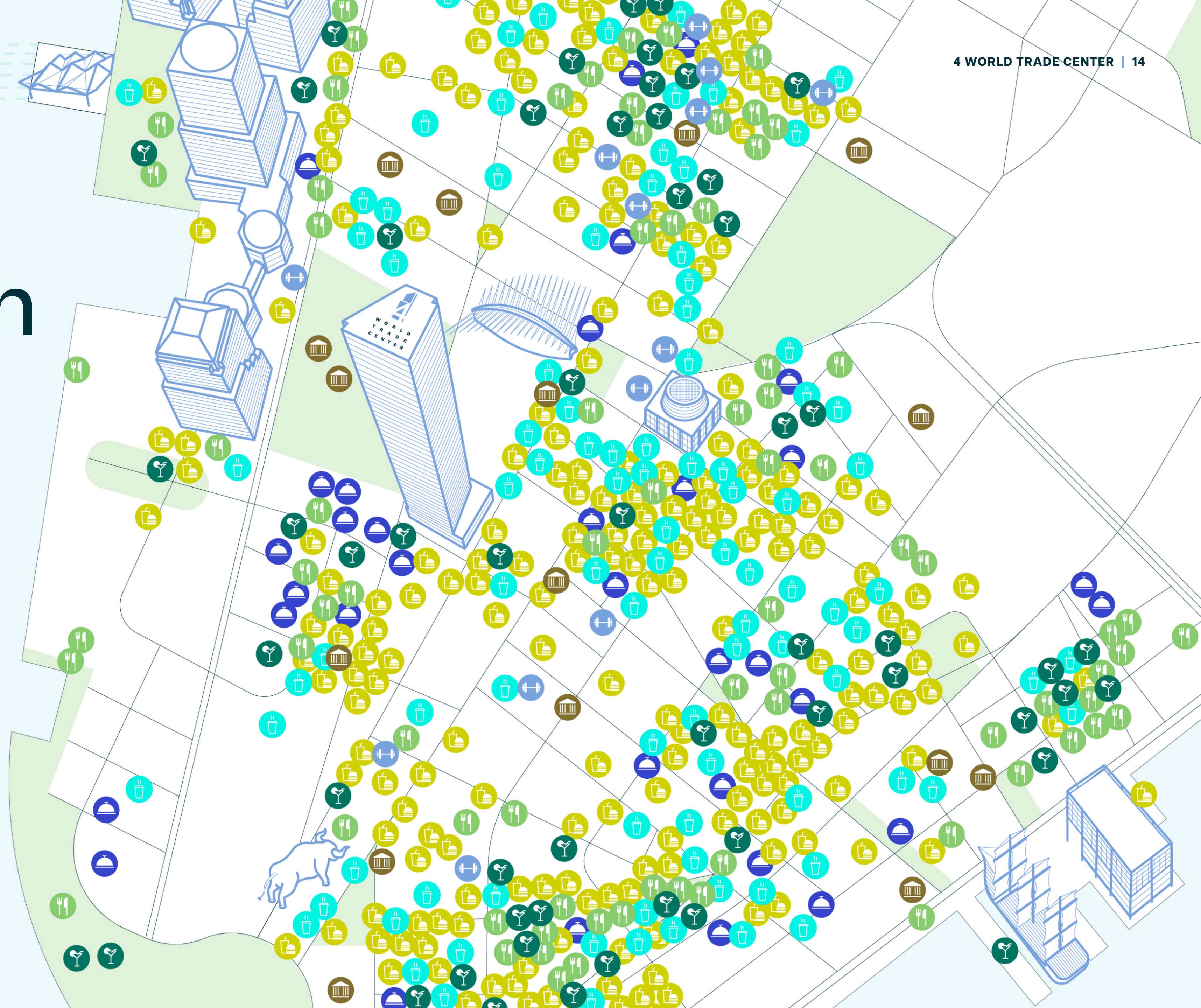



# This Neighborhood Never Sits Still

Countless hotspots to go out, restaurants to dine in, greenspaces to explore, and enough retail options to satisfy even the biggest shopping sprees. Your after-work plans just got a lot more exciting.



OCULUS BEER GARDEN



BATTERY PARK



LIBERTY BISTRO





# You Already Know Your Neighbors

Household names and the hottest up-and-comers make their home at WTC



# Where To Next?

13 min

To Grand Central Station

4 5

12 min

To Times Square

1 2 3 A C E R W

12 min

To Penn Station

1 2 3 A C E R W

11 min

To Jersey City



10 min

To Hoboken



8 min

To Union Square

4 5 R W







**KEITH A. CODY**  
212.312.9229  
kcody@silvprop.com

**GORDON L. HOUGH**  
212.313.4643  
ghough@silvprop.com